

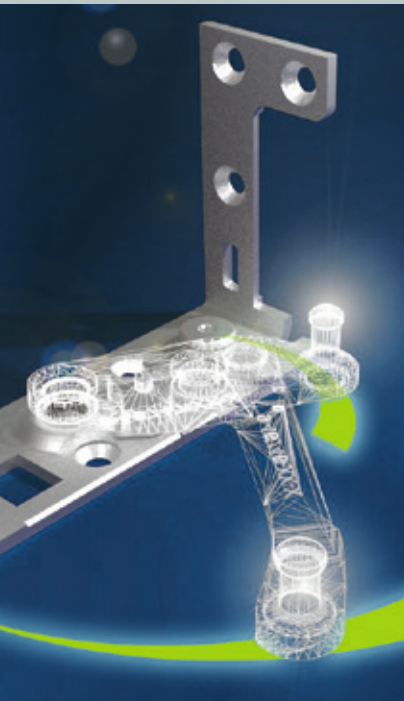

WINDOW TECHNOLOGY
DOOR TECHNOLOGY
AUTOMATIC ENTRANCE SYSTEMS
BUILDING MANAGEMENT SYSTEMS



FOR PVC AND TIMBER WINDOWS AND BALCONY-DOORS

UNI-JET SCF – the new concealed hinge-side



Securing technology for you



The new concealed hinge-side – UNI-JET SCF

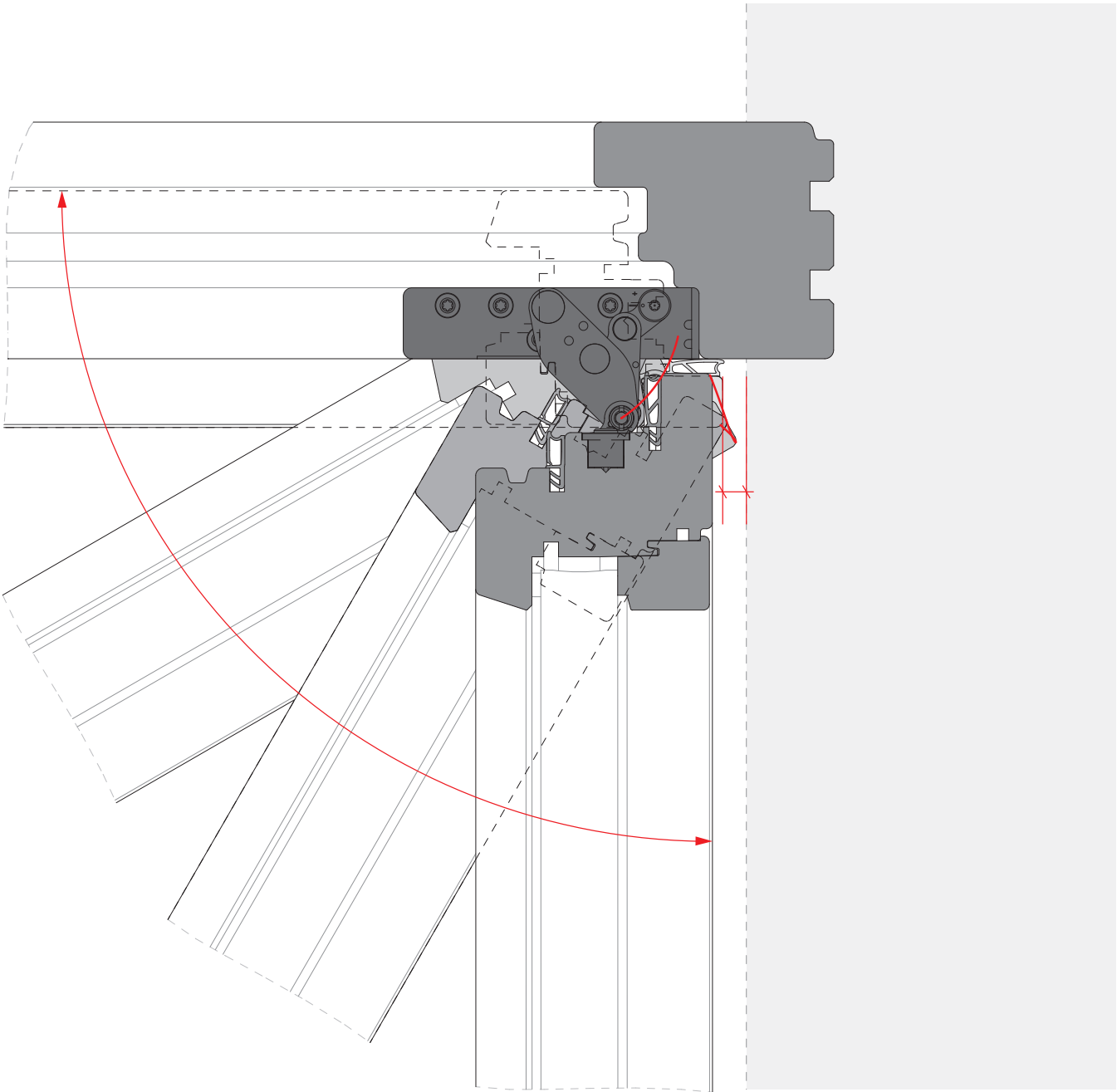

UNI-JET SCF for PVC windows

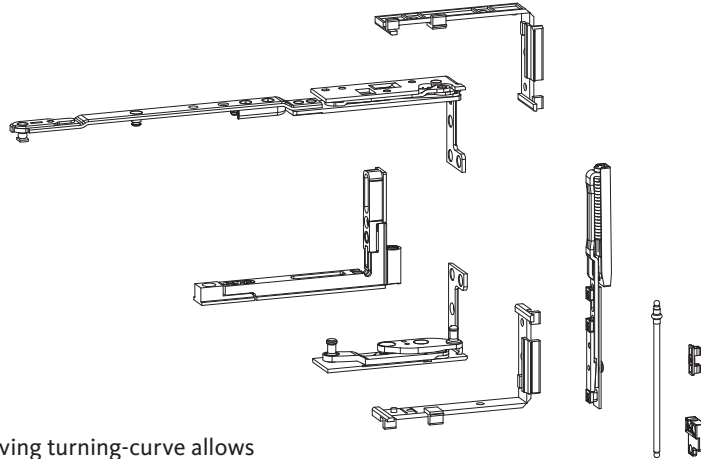

Design benefits

- The new inward-moving turning-curve allows for greater design freedom
- No visible hardware components – also suitable for use in flush windows
- Universal combination with the modular UNI-JET central locking system

Easy handling

- No window drilling required
- One-man installation possible thanks to the parallel sash hinging
- No damage to components when plastering, as they are situated in the rebate area
- One system tool for all adjustments

Possible applications

- Also with triple sashed "Swiss windows"
- Hardware load-bearing capacity tested up to 130 kg, with load-absorption set up to 160 kg
- Opening angle up to 90°
- Tested resistance classes



Interior view



Scissor action arm



The new UNI-JET SCF with new inward-moving turning-curve

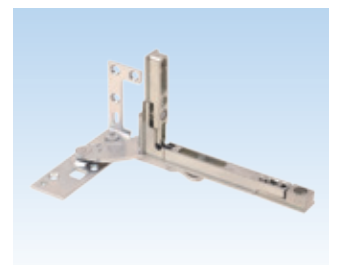

Pivot-rest

Product Overview

Description	Clearance [mm]	Axis [mm]	Sash overlap width [mm]	Tested hardware load-bearing capacity [kg]	Max. sash rebate width [mm]	Max. sash rebate height [mm]
UNI-JET SCF	12	9 / 13	max. 22	130	1400	2800
UNI-JET SCF	12	9 / 13	max. 22	160*	1400	2800

* 160 kg with optional load-absorption set

For all stated weights and dimensions, please refer to our application diagrams. For more information: www.g-u.com

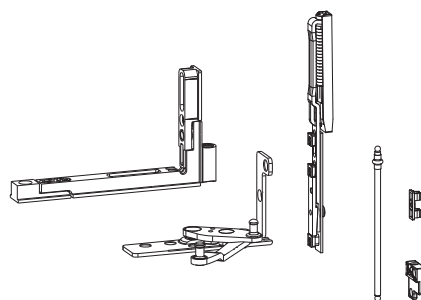
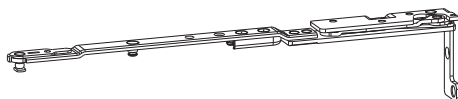

Design benefits

- The new turning-curve provides 5 mm free space on the frame, thus allowing for more design freedom
- No hardware components visible
- Universal combination with the modular UNI-JET central locking system

Easy handling

- No milling work necessary on the window
- One-man installation possible thanks to the parallel sash hinging
- No damage to components when plastering, as they are situated in the rebate area
- One system tool for all adjustments

Possible applications

- Also with triple sashed "Swiss windows"
- Hardware load-bearing capacity tested up to 130 kg, with load-absorption set up to 160 kg
- Opening angle up to 90°
- Tested resistance classes



Flush appearance with 5 mm shadow gap for windows with sash overlap

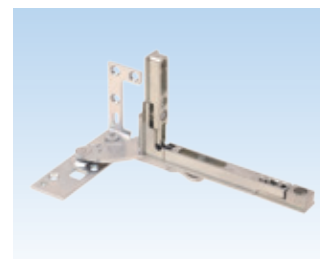

Pivot-rest



Flush appearance with 5 mm shadow gap for windows with overlap



Windows with overlap allow for larger glass areas due to narrower frames

Product Overview

Description	Clearance [mm]	Axis [mm]	Sash overlap width [mm]	Tested hardware load-bearing capacity [kg]	Max. sash rebate width [mm]	Max. sash rebate height [mm]
UNI-JET SCF	12	9 / 13	max. 22	130	1400	2800
UNI-JET SCF	12	9 / 13	max. 22	160 *	1400	2800

* 160 kg with optional load-absorption set

For all stated weights and dimensions, please refer to our application diagrams. For more information: www.g-u.com



The new UNI-JET S-CONCEALED F
with new inward-moving turning-curve

The new concealed UNI-JET SCF hinge-side

The GU Group provides a wide range of concealed hinge-sides for PVC and timber windows in order to meet high design expectations and extend the scope of window design and manufacturing freedom. The fully concealed hinges make the window profiles a visual highlight.

No compromises on design and functionality

The UNI-JET SCF hinge-sides for PVC and timber windows (with/ without overlap or with CONTURA-compatible profile) emphasise clear architectural lines and offer the same degree of safety and functionality as the face-fixed hinge-sides from the GU group.

The invisible load carrier

Sash weights up to 160 kg, floor-to-ceiling sashes up to 2800 mm and ease of operation, also in safety classes up to RC2 – the concealed hinge-sides have been found to perfectly satisfy all of the above when subjected to 15000 test cycles. The option of a barrier-free version provides an additional benefit.

More installation efficiency

With concealed hinge-sides, the sashes are hinged parallel to the frame. This allows for one-man installation. Space-saving packaging and a reduced number of components also reduce storage overheads.

Product overview

Description	PVC	Timber
Tilt&Turn hardware	UNI-JET SCF	UNI-JET SCF
Description	S = screwed	S = screwed
Sash rebate width (mm)	390 – 1400	390 – 1400
Sash rebate height (mm)	350 – 2800	350 – 2800
Tested hardware load-bearing capacity (kg)	130	130
Tested hardware load-bearing capacity (kg)	160 *	160 *

* 160 kg with optional load-absorption set
For all stated weights and dimensions, please refer to our application diagrams. For more information: www.g-u.com



WINDOW TECHNOLOGY
DOOR TECHNOLOGY
AUTOMATIC ENTRANCE SYSTEMS
BUILDING MANAGEMENT SYSTEMS

Gretsch-Unitas GmbH
Baubeschläge
Johann-Maus-Str. 3
71254 Ditzingen
Germany
Tel. +49 7156 301-0
Fax +49 7156 301-77980

BKS GmbH
Heidestr. 71
42549 Velbert
Germany
Tel. +49 2051 201-0
Fax +49 2051 201-9733

www.g-u.com

Printed in Germany
12/2016
WP00376-04-1-2



Copyright notice

© All illustrations and texts in this publication are protected by copyright. Unless otherwise stated on the image, the rights belong to the Gretsch-Unitas Group. Any use of copyright protected materials without the consent of the holder of the rights is prohibited.

Publisher

Gretsch-Unitas GmbH Baubeschläge | Johann-Maus-Str. 3 | 71254 Ditzingen, Germany
Tel. + 49 7156 301-0 | Fax + 49 7156 301-293 | www.g-u.com

Securing technology for you

